

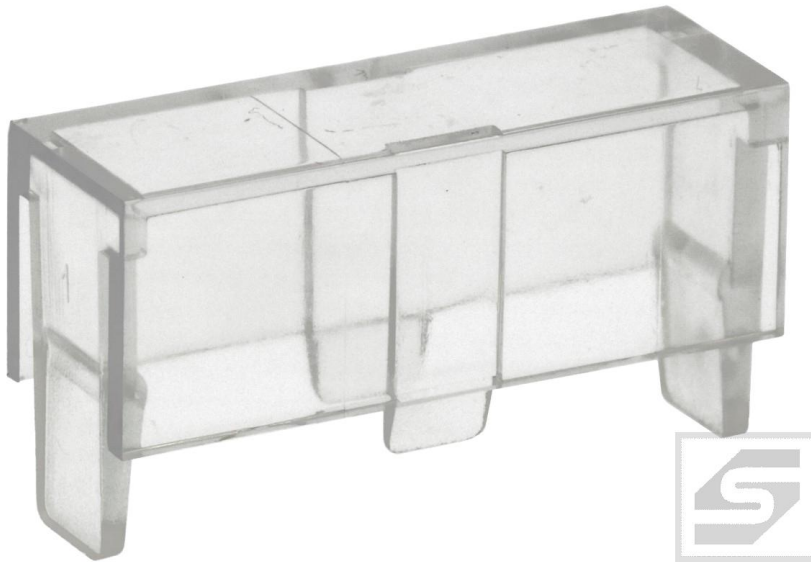

# Osłona gniazda bezpiecznika PTF/15 -BS140NA



## Dane techniczne:

Nazwa: Osłona gniazda bezpiecznika

Symbol: PTF/15 -BS140NA

Rodzaj obudowy bezpiecznika: fi 5x20mm

Sposób montażu: do gniazda

Przyłącze elektryczne: przewlekany (THT)

Maksymalny prąd pracy: 6,3A

Maksymalne napięcie pracy: 250V AC

Właściwości: przezroczyste

Producent: Stelvio

Certyfikaty: RoHS



**PORTAFUSIBILI  
FUSE- HOLDERS  
PORTE-FUSIBLES  
SICHERUNGSHALTER**

TIPO  
TYPE  
TYPE  
TYP

**PTF / 15  
PTF / 15S  
PTF / 15B**

PER FUSIBILI  
FOR FUSES  
POUR FUSIBLES  
FÜR SICHERUNGEN

**5 x 20**

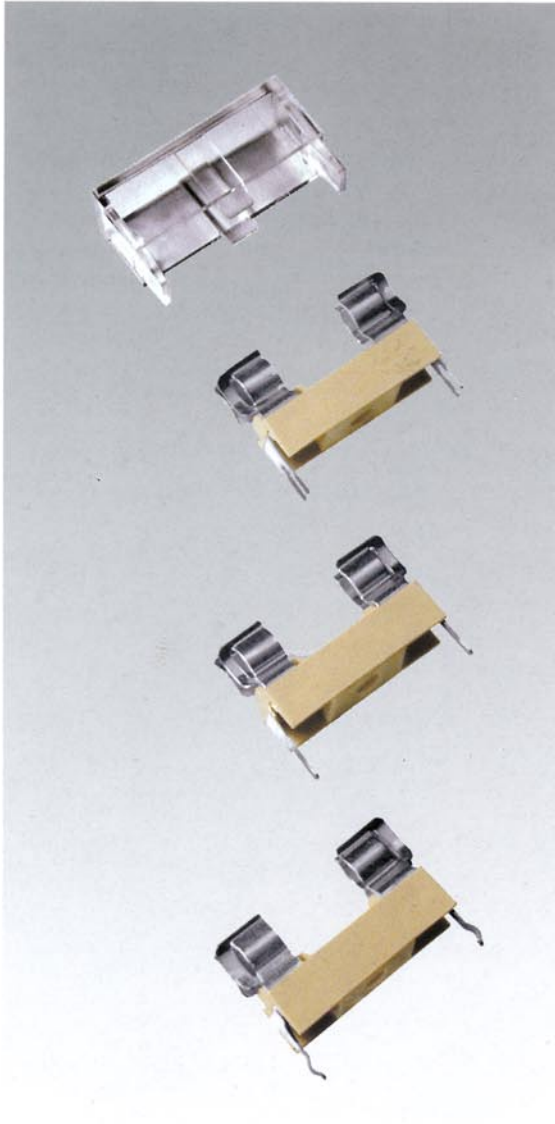

**PTF / 15**

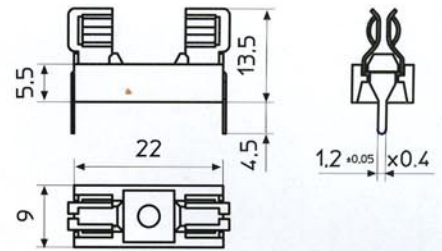
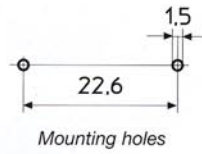

**PTF / 15S**

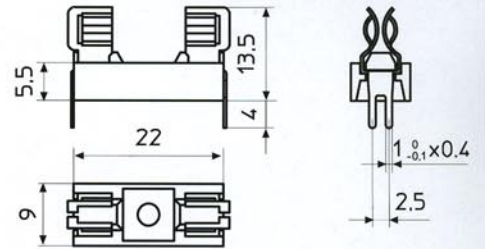
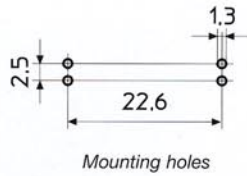

**PTF / 15B**

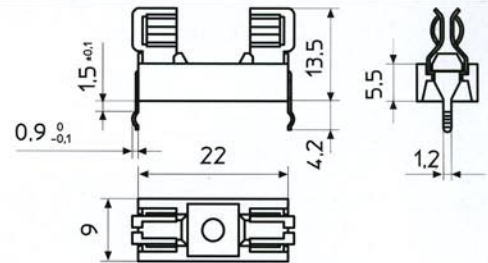
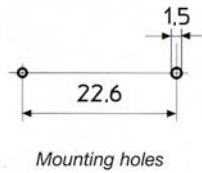

**BS140 - BS140 /A**

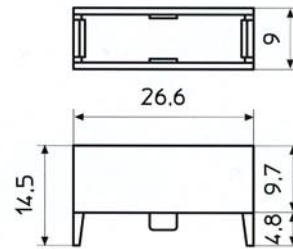

PER C.S.

FOR P.C.B.

POUR C.I.

FÜR LEITERPLATTE



Corpo isolante Beige	Insulating body Beige	Corps isolant Beige	Isolierkörper Beige	PPOM UL 94 V1
Coperchio	Cover	Couverture	Deckel	BS 140-SAN
				BS 140 A - PCUL 94 VO
Contatti	Contacts	Contacts	Kontakte	CuZn 37 + Ni + Sn
Foro di montaggio	P.C.B. mounting hole	Perçage C.I.	Leiterplattenbohrung	Ø 1,3 ÷ 1,5 mm
Categoria	Class	Catégorie	Baureihe	PC1
Corrente nominale	Nominal current	Courant nominal	Strombelastbarkeit	6,3 A
Tensione	Voltage	Tension	Betriebsspannung	250 V
Potenza dissipabile	Operating power	Puissance dissipable	Ausgangsleistung	1,6 W
Resistenza di contatto	Contact resistance	Résistance de contact	Übergangswiderstand	< 5 m Ω
Resistenza di isolamento	Insulation resistance	Résistance d'isolement	Isolationswiderstand	>10 <sup>2</sup> M Ω
Rigidità dielettrica	Dielectric strength	Rigidité diélectrique	Durchschlagsfestigkeit	> 3000 Vac / 60 "